



REGAL DRAPES

Somfy Motorized Track – Installation Instructions

Materials

Please read through all instructions carefully before you begin. Unpack all materials, making sure all parts are included:

Mounting Brackets

Track

Motor

Remote Control

Screws & Anchors

Splice (optional)

Tools Needed

Drill with Phillips screwdriver bit

Phillips Screwdriver

Pencil

Metal Tape Measure

Level (wall mount)

Step Ladder

Track Installation

The Somfy motorized track can be **wall or ceiling mounted**. Specific brackets are used for each application. Tracks greater than 96" may require splices. If your track does not require a splice, skip to step 2.



Step 1 – Splice track

Insert Splice onto one end of the track, if already attached to one track, loosen the screws. Bring both ends of the tracks together, tucking the belt into the track by bringing the master carrier and belt tension device together. This will tighten the belt, allowing the tracks to be brought together.

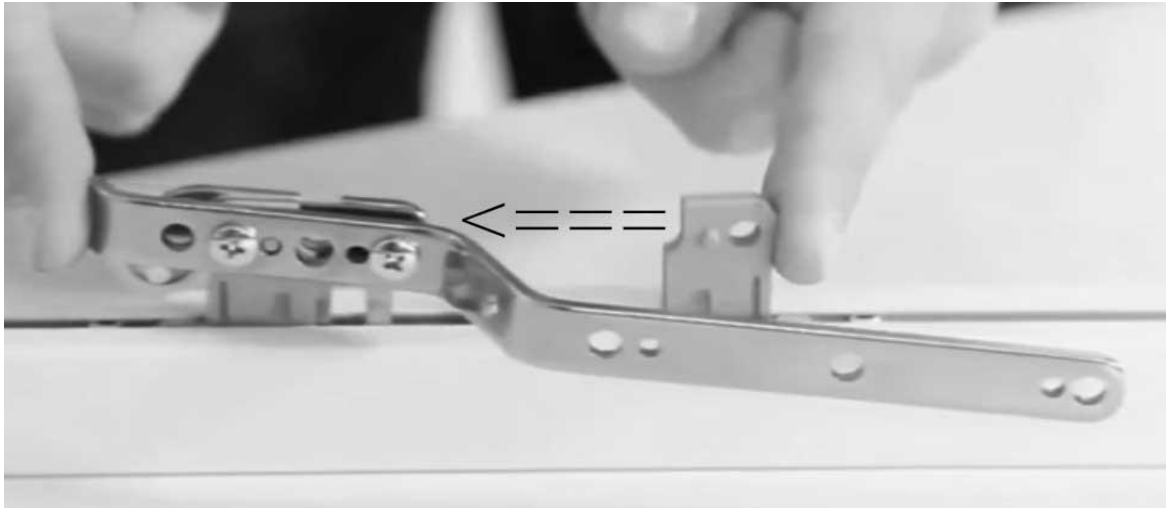

Once both ends are together, place splice evenly across both tracks. Use a Phillips Head screw driver to tighten screws and secure splice onto both tracks.



Loosen the screws on the master carrier and remove latch.



Bring the loose carrier together and join with the latch piece. Reattach the master carrier to both pieces.



Step 2 – Determine Track Height (Wall Mount, If Ceiling mount Skip to Step 4B)

Most of the time we recommend centering on window/door. Determine the height of the top of the track and mark bracket height on the wall for all the brackets. Adjust as necessary to make sure they are all level and in a straight line. The recommended method to determine height is to add 1 ½ inches to the length of your drapery panel. For example: if drapery panels are 84" L the top of the track would be installed at 85 ½" allowing a ¼" clearance above the floor.

Step 3 – Bracket Placement

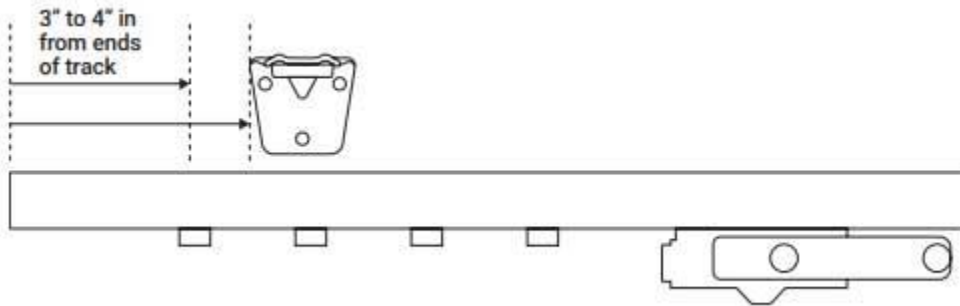

Measure the width of the track and mark the two end brackets approximately 3"-4" in from ends of the track. Evenly space the remaining brackets and place corresponding marks. We also recommend that the remaining brackets be placed every 16-24" (We recommend placing brackets on studs, if not possible use heavy duty anchors.)

Step 4A – Mount Brackets (Wall Mount)

Attach mounting clip to wall bracket by removing the front two screws and placing clip in place and screwing back in. The small lip should be facing out after attached to bracket. (TIP – The two rear screws on the bracket can be loosened to adjust the projection of the track.)

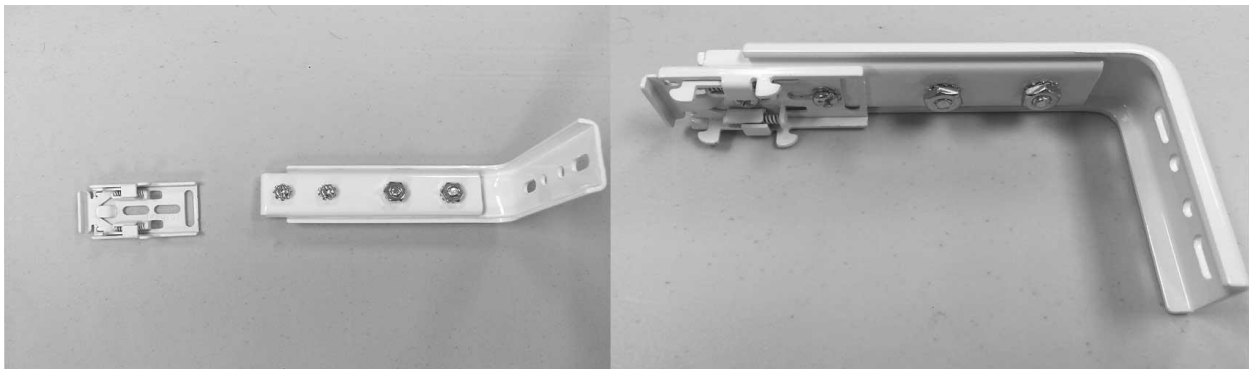

For wood frame header or wall stud locations drive provided screws directly into wall. When studs are not located where bracket is installed, use Phillips bit to drive provided anchor into sheetrock and then screws into the anchors.

Step 4B - Ceiling Mount Bracket Install

Most of the time we recommend centering on window/door. Measure the width of the track and mark the two end brackets approximately 3" - 4" in from the ends of the track, preferably on

ceiling joists. Brackets should be a minimum of 3" from the wall. Evenly space the remaining brackets, preferably on ceiling joists, and place corresponding marks in a straight line.

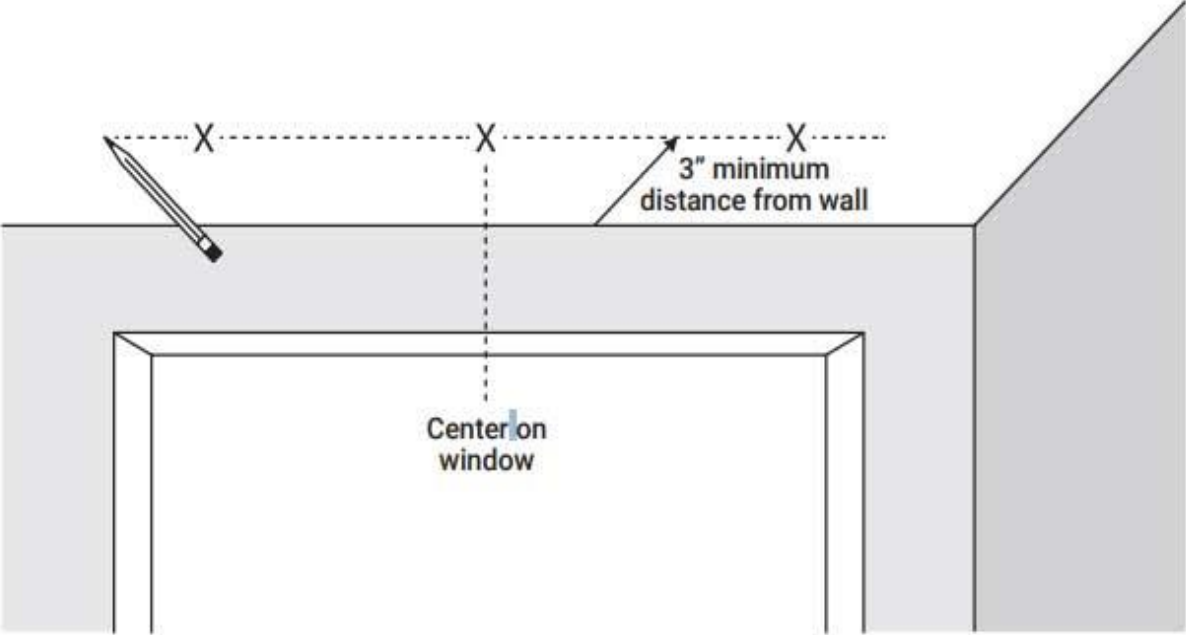

Ceiling Bracket

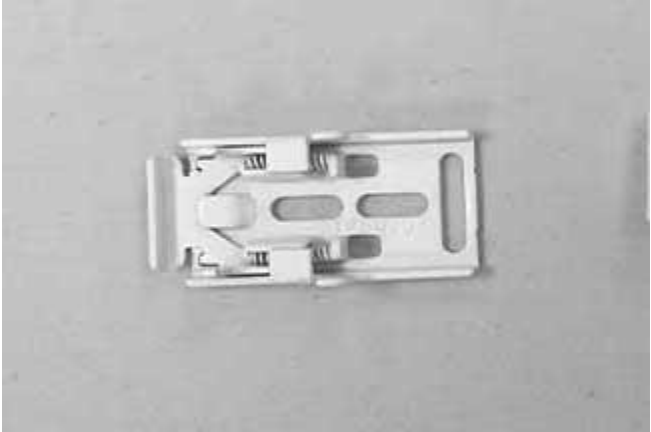

For ceiling joist locations, drive provided screws directly into ceiling. When ceiling joists are not located where bracket is installed, use Phillips bit to drive provided anchor into sheetrock and then screws into the anchors. The provided anchors must be used to install brackets for standard sheetrock. *For other wall types, use appropriately rated anchors (not included).

Step 5 – Attach Track to Brackets

The Somfy track uses One touch Ceiling brackets. Attach track to the brackets by leaning track onto back clips. Using your thumbs, push the bracket in and pop track into place onto the front of the bracket. The bracket will snap into the track once it is attached.



Step 6 – Attach Motor

Unlock Motor by moving plastic tab at the top of motor. Attach motor to track and lock tab into place.

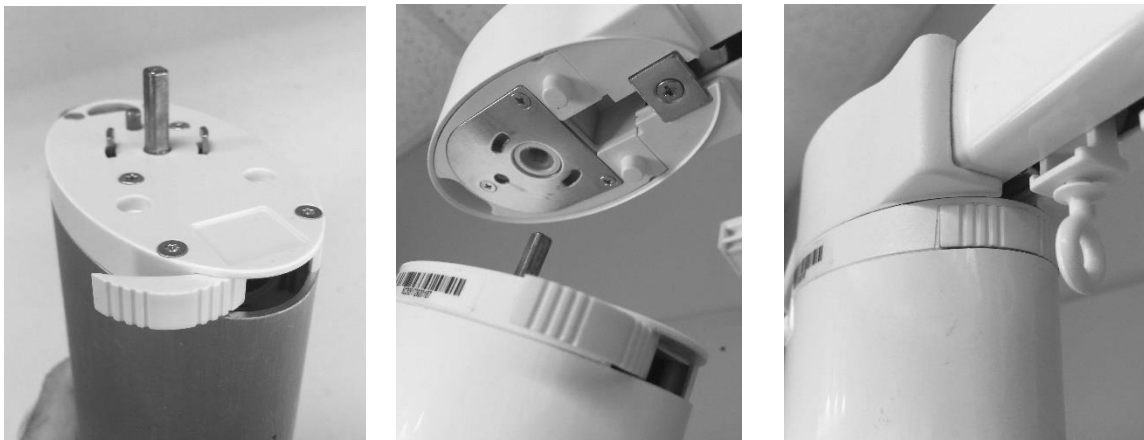

If using a motor with a battery, attach the battery to the bottom of the motor.

Step 7 – Test Track Operation

Make sure that the motor is plugged in (If using battery, make sure that it is charged). Use the remote to test that track is opening and closing properly.

The remote control includes instructions if it needs to be reprogrammed.

If using the Somfy MyLink system, plug it into an outlet, download “Somfy MyLink” onto your smart phone from the App Store and follow on screen instructions.

Step 8 – Attach drapery to track (see installing drapery instructions).